

# TOWNSHIP 17 NORTH RANGE 60 WEST

6th Principle Meridian  
Laramie County, Wyoming

Tax District 0203 Fire District 3 School District 2

## OWNERSHIP AS OF JANUARY 1, 2010

MAP #	YEAR	OWNERSHIP	STATE	COUNTY
001		MAY, THOMAS E.	022-001	0201.0
002		SOERSON, LARRY W. ET UX	024-001	0202.0
003		SCHOVLAIN, NANCY ANN ET AL	031-001	0302.0
004		HOLGERSON RANCH CO.	041-001	0401.0
005		BOW TREE LAND CO., LLC	181-001	1801.0
006		MC LAUGHLIN, JOHN C. LIVING TRUST ET AL	042-002	0405.0
007		MC LAUGHLIN, JOHN C. ET UX (IMPS ONLY)	043-001	0404.0
008		MC LAUGHLIN, LEANN M. LIVING TRUST	051-004	0503.0
009		R MILL IRON LAND AND CATTLE RANCH LLC	062-002	0604.1
010	2010	CHAMP LLC	263-005	2602.0
011		3M TROUT RANCH, INC.	273-001	2700.2
012		JESSEN PROPERTIES, INC.	172-001	1700.0
013		MALM TROUT RANCH INC.	334-002	3300.3
014		CHAMP LLC	334-003	3300.4
015		FREEBURG FARMS, INC.	084-001	0807.0
016		WHITEHEAD, STEVEN J. ET UX	153-016	1503.0
017		SOERSON FAMILY LIVING TRUST	091-003	0903.0
018		OLIVERIUS, CALVIN J.	093-001	0900.0
019		OLIVERIUS, CALVIN J., JR.	091-005	0902.2
020		ANDERSON, GRACE L.	091-001	1001.0
021		WENZEL, F. BERNARD ET AL	101-002	1002.0
022		HOLGERSON, WILLIAM L. ET UX	103-001	1004.0
023		PALM-EGLE LAND CO., INC.	112-001	1101.0
024		FREEBURG, JOHN W. TRUST	152-001	1502.0
025		PRAIRIE TRUST	152-003	1505.0
026		ACTION COMMUNICATIONS	042-003	0406.0
027		FREEBURG, TROY ET UX	211-027	2101.0
028		STATE OF WYOMING STATE LANDS	161-001	1601.0
029		PETERSON, BRUCE MICHAEL ET ZL	192-001	1901.0
030		US GOVERNMENT - BLM	163-001	1602.0
031		LARSON, RICHARD REVOCABLE TRUST ET AL	194-001	1904.0
032		HOLGERSON RANCH CO.	202-001	2002.0
033		HOLGERSON RANCH CO.	203-002	2005.0
034	2010	BENEFICIAL WYOMING, INC.	203-003	2006.0
035		FREEBURG FARMS, INC.	201-001	2001.0
036		SANDERSON, JEREMY L. ET UX	84-004	0809.0
037		PRAIRIE TRUST	222-001	2201.0
038		MALM RANCH COMPANY LIMITED PARTNERSHIP	213-001	2102.0
039		ALBIN BAPTIST CHURCH	301-002	3006.0
040		MALM RANCH COMPANY LIMITED PARTNERSHIP	333-001	3300.5
041		SMITH, GRANT T. ET UX	281-002	2800.0
042		SMITH, GRANT T. ET UX	281-001	2801.0
043		STERLING TRUST CO.	17-61	17-61
			132-001	1300.0

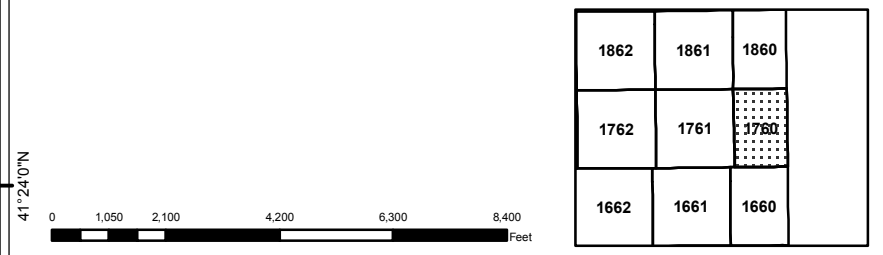

THIS MAP IS MADE POSSIBLE THROUGH THE CHEYENNE AND LARAMIE COUNTY COOPERATIVE GIS (CLCCGIS) PROGRAM AND IS FOR DISPLAY PURPOSES ONLY. THE CLCCGIS INVOKES ITS SOVEREIGN AND GOVERNMENTAL IMMUNITY IN ALLOWING ACCESS TO OR USE OF THIS DATA, MAKES NO WARRANTIES AS TO THE VALIDITY, AND ASSUMES NO LIABILITY ASSOCIATED WITH THE USE OR MISUSE OF THIS INFORMATION.

THESE MAPS ARE DIAGRAMMATIC LAYOUTS OF PROPERTY OWNERSHIP FOR THE PURPOSE OF SHOWING LOCATION. ACCURACY OF THE DATA IS CONSISTENT WITH THIS INTENDED USE. NO ASSUMPTION IS MADE TO THE ACCURACY OR SCALE AS SHOWN.